

Michelle Nicholson
440.539.3545
mnicholson@irgicp.com



OFFICE REDEVELOPMENT / MANUFACTURING / WAREHOUSE

2424 West 23rd Street, Erie, Pennsylvania 16506



Property Details

- Total Building: 511,000 SF
- Available: 122,469 SF
- Acres: 26
- Rate: \$7.25 psf NNN
- Open Floor Plates
- Abundant Parking
- Potential Indoor Parking
- Low Operating Costs

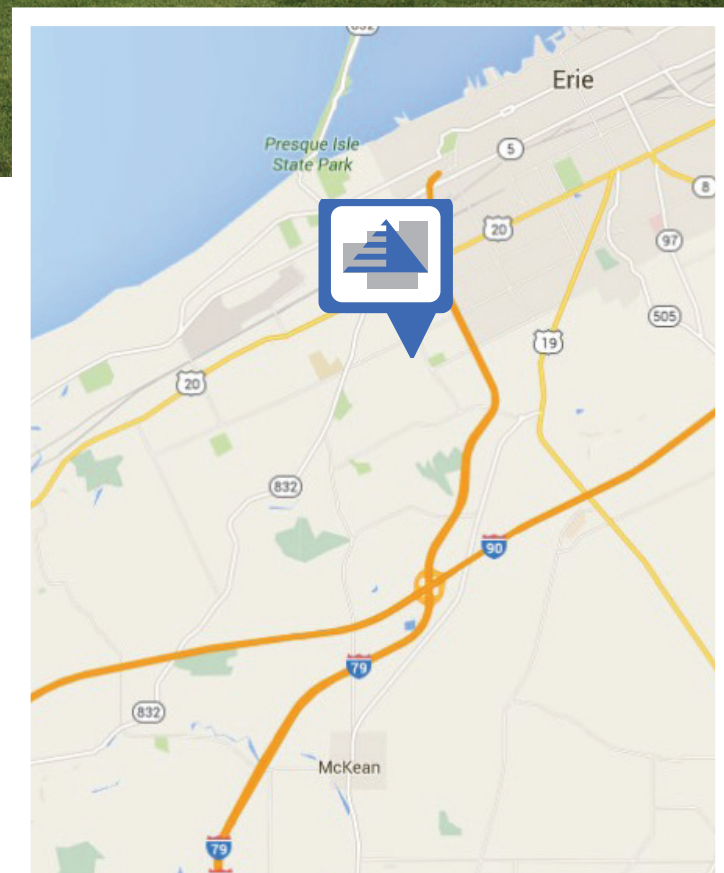

OFFICE REDEVELOPMENT / MANUFACTURING / WAREHOUSE

2424 West 23rd Street, Erie, Pennsylvania 16506



IRGICP
Commercial Real Estate

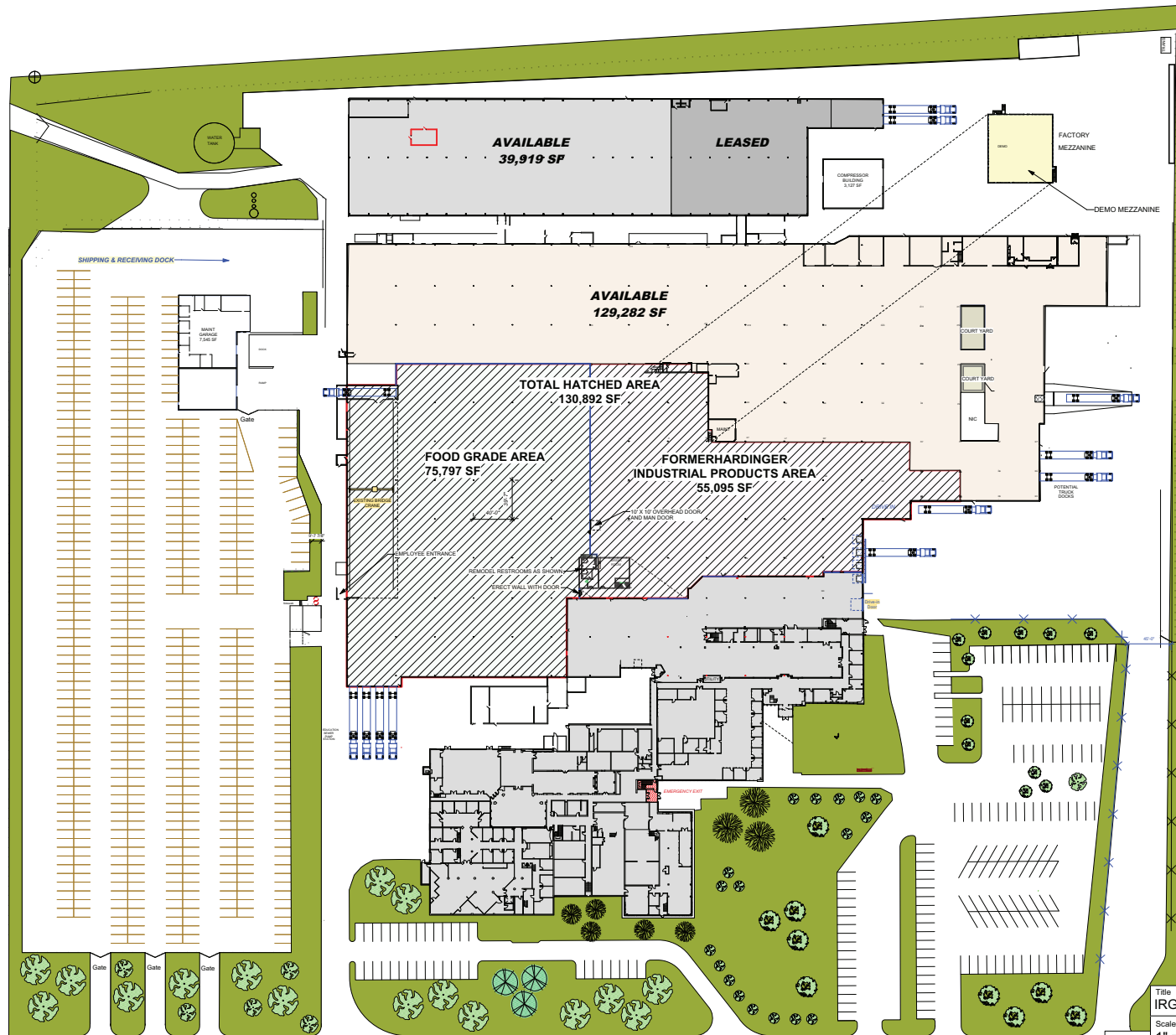

Title
IRG-ERIE CURRENT LAYOUT

Scale 1" = 50'	When printed on D SIZE	Drawn by J.Supanich	Date 4/26/2018
--------------------------	----------------------------------	-------------------------------	--------------------------

File Name IRG-ERIE CURRENT LAYOUT.vwx

